

Features:

- Three arms for smooth and stable movement so you can see the TV from any angle
- Wall plate cover hides the screws for a clean modern finish
- Built-in spirit level for faster and more accurate installation
- NEO cushioned pads protect the TV from scratches and improve audio insulation
- Save space in your room and keep the TV away from children and pets
- Confidently mount your screen with a high 25kg maximum weight limit
- Suits 13" - 23" TVs, compatible with 75x75 - 100x100 VESA sizes
- Includes fixings for solid walls, stud walls and the TV, for convenience
- High quality steel construction with independent testing by SGS
- Reassurance of a 5 year warranty as standard

Get total control of your TV or monitor's position with this full motion wall mount. Always have a great view of the screen wherever you are in the room. It is perfect if you want to move it around or to place the TV in a corner. Rotate the screen left or right (-/+90°) and tilt it up or down (-5°/+15°) to get the perfect viewing angle and reduce glare. Extend the TV outwards for easy access to cables, or push it back neatly against the wall. Once installed, no tools are needed to change the position or angle of the TV. The mount is fitted in two parts - one to the TV, one to the wall. Simply lift and slide the TV onto the wall mount and then tighten the locking screw to secure it. NEO cushioned pads protect the TV from scratches and provide insulation for improved audio. Compatible with VESA sizes 75x75 - 100x100mm.

Technical Specifications:

Max Load	Distance from wall (Folded)	Distance from wall (Extended)	Swivel Range	Tilt Range	No of Articulation Points	Mounting Pattern	VESA Compatible
25Kg/ 55lbs	76mm/ 3.0"	358mm/ 14.1"	±90°	-5°/+15°	4	Single Stud & Solid Wall	75x75 to 100x100



Packed image



Line drawing

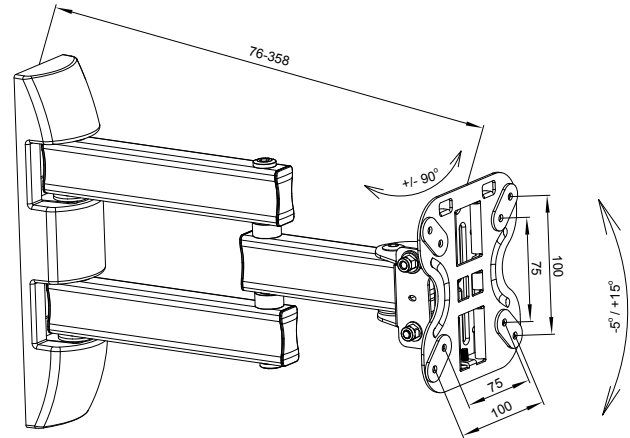

All dimensions are in mm

Packaging Information:

Product Number	Description	Product Packaging		Outer Packaging		
		Type	Barcode	Type	Qty in Box	Barcode
LN2TA100-RO	Triple Arm Full Motion TV Wall Mount	Colour Gift Box	5015056591766	Brown Outer with Label	4	05015056544373

Weight & Dimensions:

Product			Product Box			Outer Box		
Extended	Folded	Net Weight	Dimensions	Gross Weight	Cubic	Dimensions	Gross Weight	Cubic
25.5 x 12 x 35.8 cm	25.5 x 21.4 x 7.6 cm	1.93kg	21.5 x 27.5 x 7.5 cm	2.11kg	0.0044m ³	44.5 x 30 x 18 cm	8.94kg	0.0240m ³
10.04" x 4.72" x 14.09"	10.04" x 8.43" x 2.99"	4.25lbs	8.46" x 10.83" x 2.95"	4.65lbs	0.1566ft ³	17.52" x 11.81" x 7.09"	19.71lbs	0.8486ft ³