

**Features:**

- Six arms give your TV unbeatable stability, smooth movement and a premium finish
- Long arms extend the screen further out from the wall, giving you easy access to cables
- Spirit level included for faster and more accurate installation
- NEO cushioned pads protect the TV from scratches and improve audio insulation
- Save space in your room and keep the TV away from children and pets
- Confidently mount your screen with a high 50kg maximum weight limit
- Suits 50" - 85" TVs, compatible with 100x100 - 600x400 VESA sizes
- Includes fixings for solid walls, stud walls and the TV, for convenience
- High quality steel construction with independent testing by SGS
- Reassurance of a 5 year warranty as standard

Two sets of triple arms combine to deliver smooth movement and unbeatable stability. The ease of motion makes this mount ideal for media walls and any location where the screen will be regularly moved around. Gives you full control of the screen's position with turn adjustment (-/+65°) and tilt adjustment (-/+15°). The extended length arms bring the TV out further for more viewing options, then smoothly push back against the wall. Features concave shaped arms for additional strength and includes a spirit level for accurate installation. NEO cushioned pads protect the TV from scratches and provide insulation for improved audio. Compatible with VESA sizes 100x100 - 600x400mm.

**Technical Specifications:**

Max Load	Distance from wall (Folded)	Distance from wall (Extended)	Swivel Range	Tilt Range	No of Articulation Points	Mounting Pattern	VESA Compatible
50Kg/ 110lbs	110mm/ 2.9"	633mm/ 24.9"	±65°	±15°	4	Double Stud & Solid Wall	100x100 to 600x400



**Packed image**

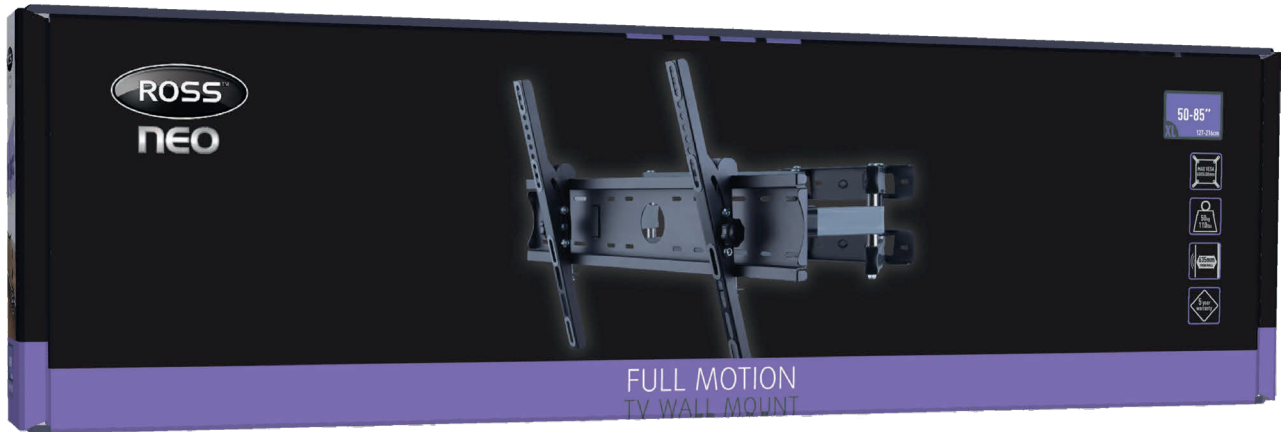

**Line drawing**

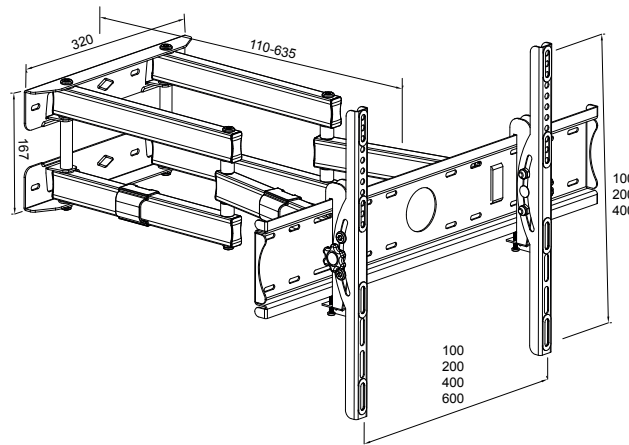

All dimensions are in mm

**Packaging Information:**

Product Number	Description	Product Packaging		Outer Packaging		
		Type	Barcode	Type	Qty in Box	Barcode
LN2RFM600XL-RO	XL Six Arm Cantilever Full Motion TV Wall Mount	Colour Gift Box	5015056591896	Brown Outer with Label	2	05015056544496

**Weight & Dimensions:**

Product			Product Box			Outer Box		
Extended	Folded	Net Weight	Dimensions	Gross Weight	Cubic	Dimensions	Gross Weight	Cubic
66.8 x 43 x 63.3 cm	66.8 x 43 x 11 cm	6.95kg	24.5 x 84.5 x 7 cm	7.59kg	0.0145m <sup>3</sup>	16 x 26.5 x 86.5 cm	15.5kg	0.0367m <sup>3</sup>
26.30" x 16.93" x 24.92"	26.30" x 16.93" x 4.33"	15.32lbs	9.65" x 33.27" x 2.76"	16.73lbs	0.5118ft <sup>3</sup>	6.3" x 10.43" x 34.06"	34.17lbs	1.2952ft <sup>3</sup>